

LOWELL HIGH SCHOOL

PARENT FORUM

FEBRUARY 2020

PERKINS —
EASTMAN



LOOKING FORWARD

OVERALL PROJECT SCHEDULE

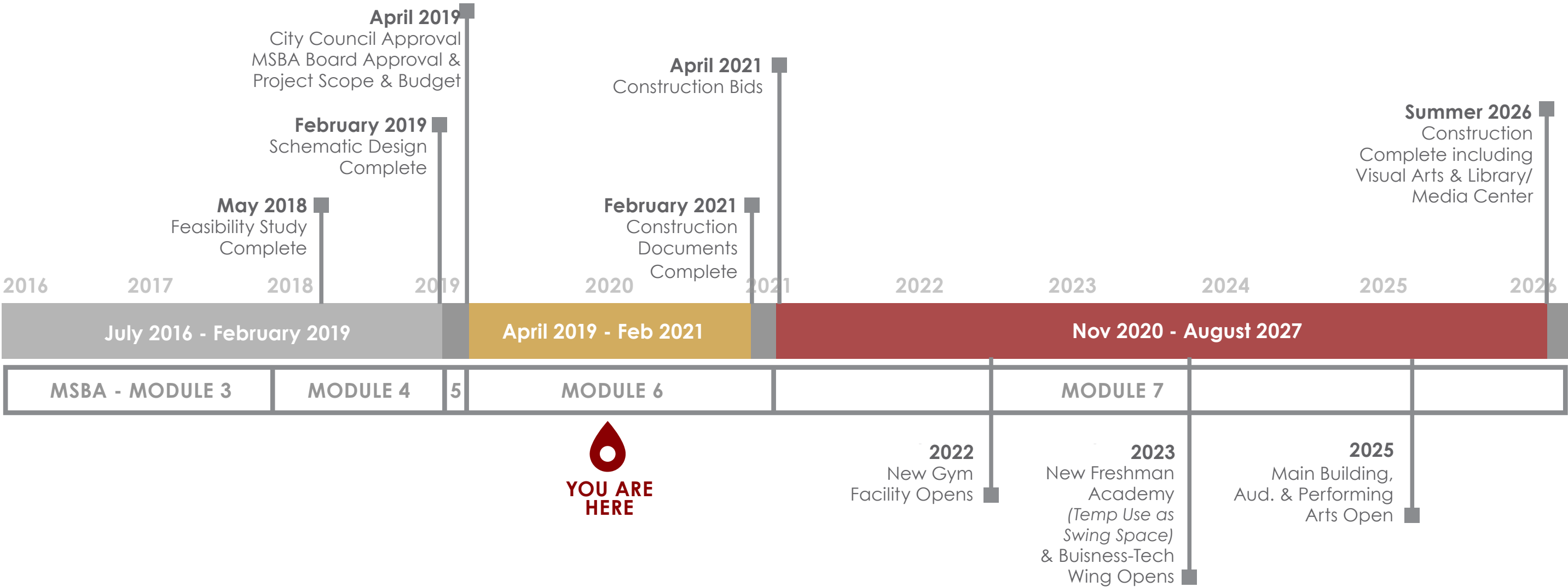



AERIAL VIEW OF EXISTING CAMPUS



AERIAL VIEW OF PROPOSED CAMPUS

SITE PLAN



BUILDING FEATURES

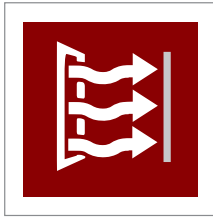

**HIGH
PERFORMANCE
ENVELOPE**

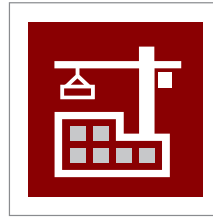

**TRANSFORMATIVE
RENOVATION**



**21ST CENTURY SCIENCE
AND ENGINEERING
LABORATORIES**

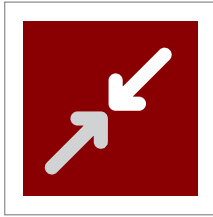

**CAMPUS CONNECTIVITY
(INCLUDES FRESHMAN
ON CAMPUS)**

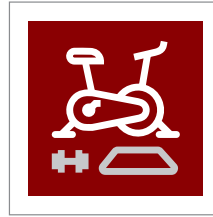

**STATE-OF-THE-ART
ATHLETIC
FACILITIES**

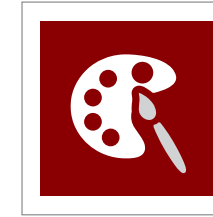

**TRANSFORMATIVE
FINE ARTS SUITE
OF STUDIOS**

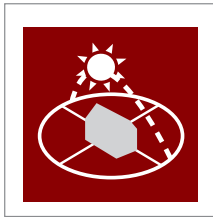

**IDEAL SOLAR ORIENTATION
FOR NEW CONSTRUCTION
CLASSROOMS**

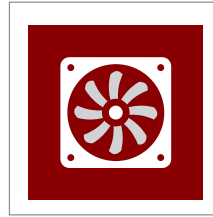

**HIGH-EFFICIENCY
MECHANICAL
SYSTEMS**

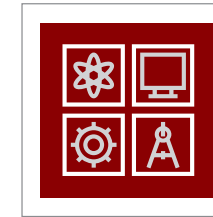

**STEM & HUMANITIES
CLASSROOM
CLUSTERS**

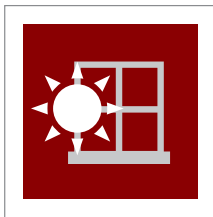

**ALL CLASSROOMS
RECEIVE NATURAL
DAYLIGHT**



**DURABLE, EASY
TO MAINTAIN
MATERIALS**

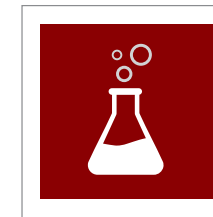

**FRESHMAN CLUSTER
OF CLASSROOMS
WITH SCIENCE LABS**



LHS
Est. 1831

LOWELL HIGH SCHOOL

VIEW OF FRONT ENTRY ACROSS FATHER MORISSETTE



HEART OF THE SCHOOL



VIEW OF THE QUAD/OPEN GREEN SPACE



LOWELL

LOWELL

LOWELL HIGH SCHOOL ROWING

GYMNASIUM



DINING COMMONS



Industry
place
culture
LOWELL
MERRIMACK diversity

CONNECTION TO CANAL



MEDIA CENTER

LOOKING FORWARD

BENEFITS OF LHS PROJECT BY GRADUATING CLASS

LHS Project - Timeline

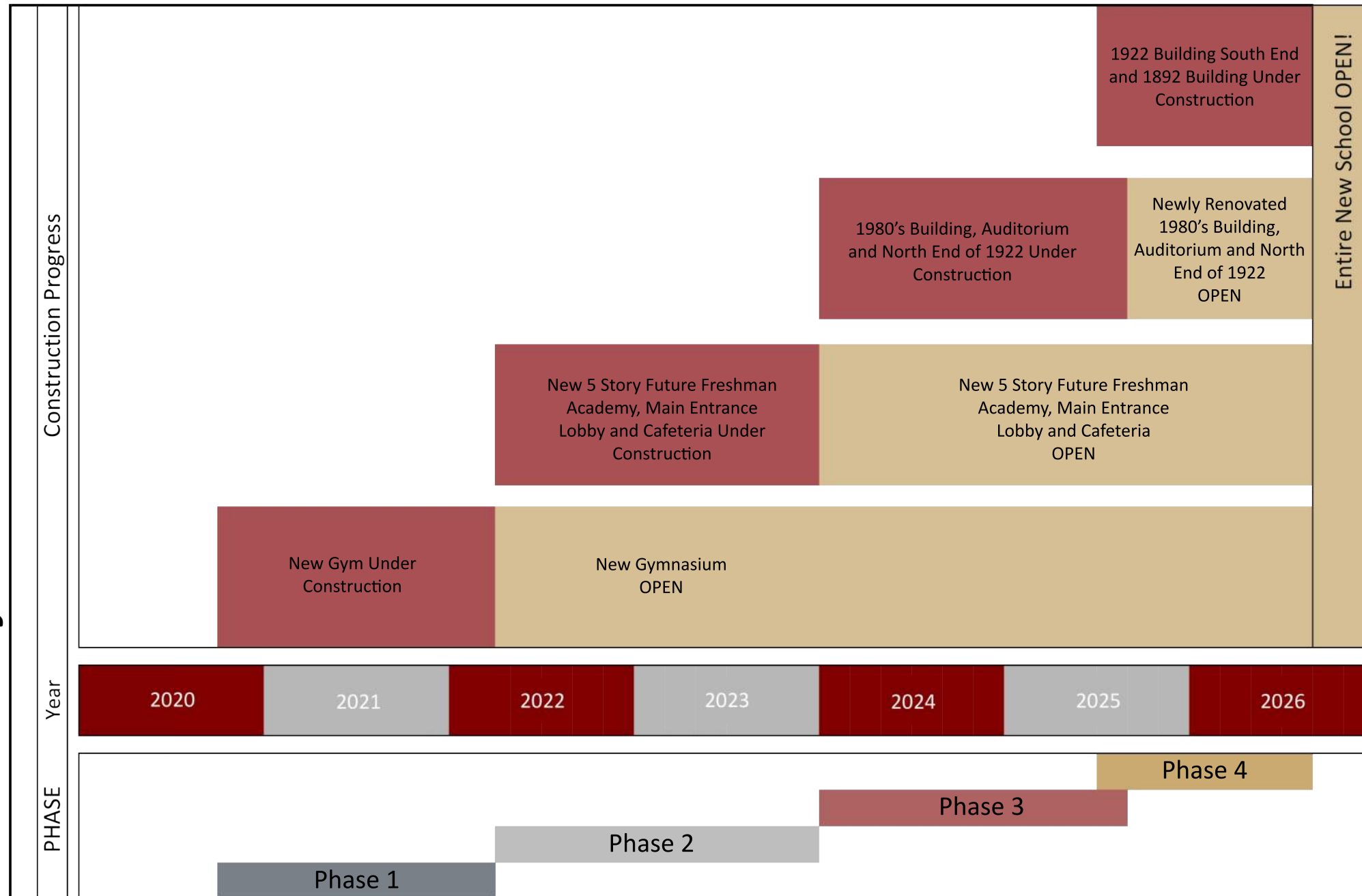

* BASED ON CURRENT ANTICIPATED SCHEDULE

LOOKING FORWARD

BENEFITS OF LHS PROJECT BY GRADUATING CLASS

Graduating Class	Grade at Start of 2019 School Year	Benefits of the LHS Project
2020	12th	No impacts. Construction will commence in the Fall Semester after their graduation.
2021	11th	No impacts.
2022	10th	Use of the New Gymnasium Facility for 1/2 of their senior year.
2023	9th	Use of the New Gymnasium Facility for 1 1/4 years.
2024	8th	Use of the New Gymnasium Facility for 2 1/4 years Use of the New Freshman Academy Classrooms for 1/2 of their senior year Use of the New Science Labs for 1/2 of their senior year
2025	7th	Use of the New Gymnasium Facility for 3 1/4 of high school Use of the New Freshman Academy Classrooms for 1 1/2 years Use of New Science Labs for 1 1/2 years
2026	6th	Use of the New Gymnasium Facility for all years of high school Use of New Freshman Academy Classrooms for 2 1/2 years Use of New Science Labs for 2 1/2 years Complete use of Renovated 1980s and North 1922 Building for 1 year
2027	5th	Use of the New Gymnasium Facility for all years of high school Use of New Freshman Academy Classrooms for 3 1/2 years of high school Use of New Science Labs for 3 1/2 years of high school Complete use of Renovated 1980s Building and North 1922 Building for 2 years Complete use of 1922 and 1892 Buildings for 1 year
2028	4th	Use of the New Gymnasium Facility for all years of high school Use of New Freshman Academy Classrooms for all years of high school Use of New Science Labs for all years of high school Complete use of Renovated 1980s Building and North 1922 Building for 3 years Complete use of 1922 and 1892 Buildings for 2 years
2029	3rd	Use of the New Gymnasium Facility for all years of high school Use of New Freshman Academy Classrooms for all years of high school Use of New Science Labs for all years of high school Complete use of Renovated 1980s Building and North 1922 Building for all years of high school Complete use of 1922 and 1892 Building for 3 years
2030	2nd	Full use of the New and Renovated Buildings with no obstruction.

* BASED ON CURRENT ANTICIPATED SCHEDULE

PHASING PLAN

EXISTING CAMPUS

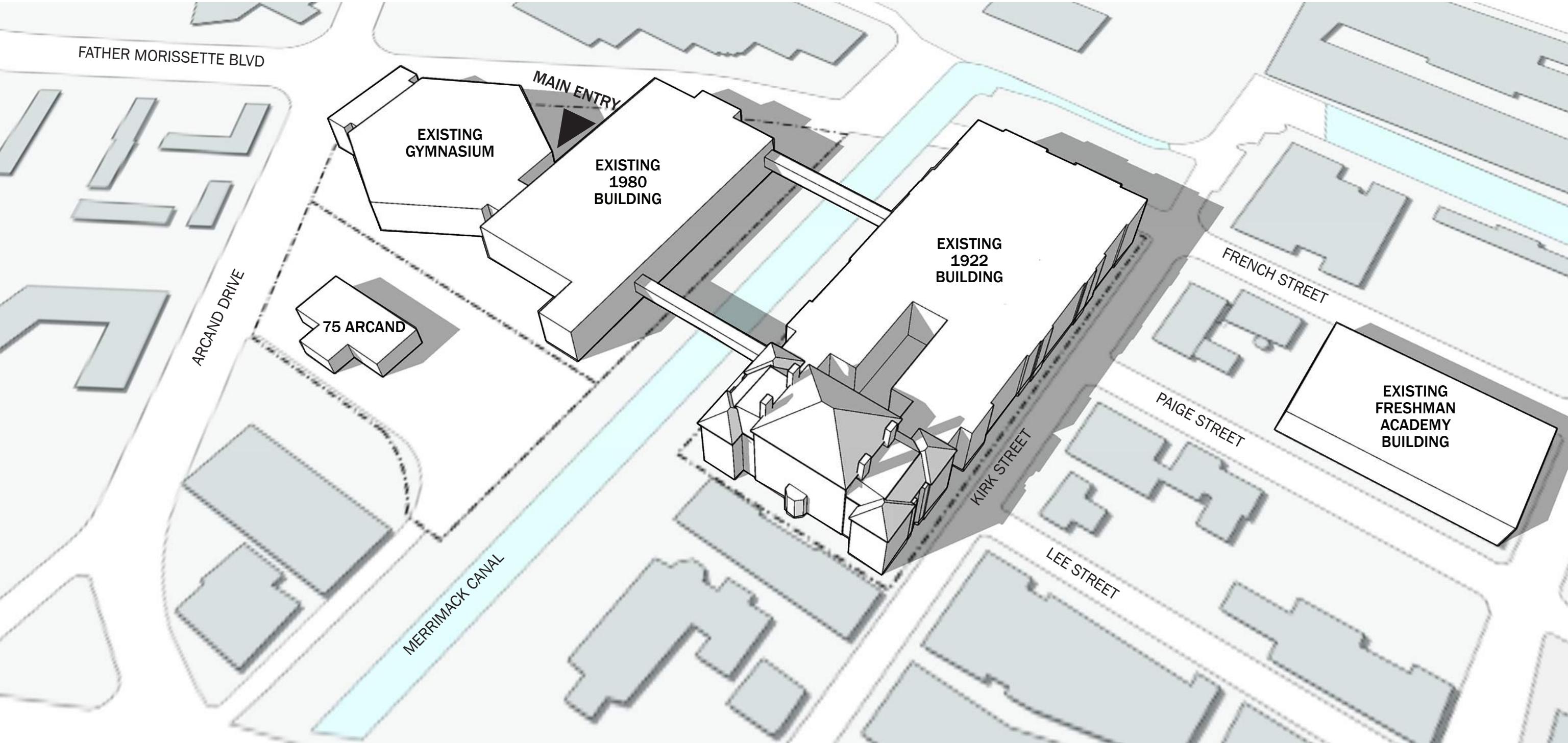

PHASING PLAN

FALL '00 - SPRING '21

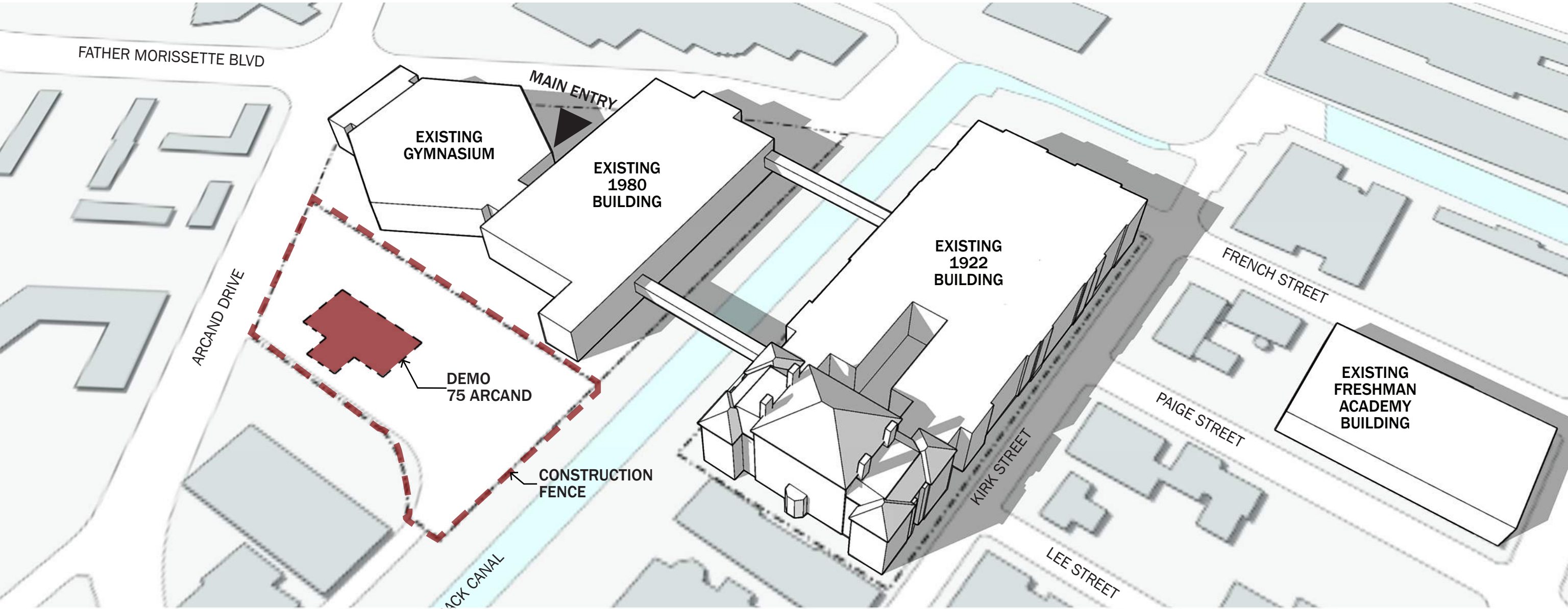

PHASE 1 & 1A

FALL '20 – SPRING '22

- ALL WORK IS OFF-SITE (SCHOOL UNAFFECTED)
- DEMOLISH 75 ARCAND

PHASING PLAN

SPRING '21 - SPRING '22

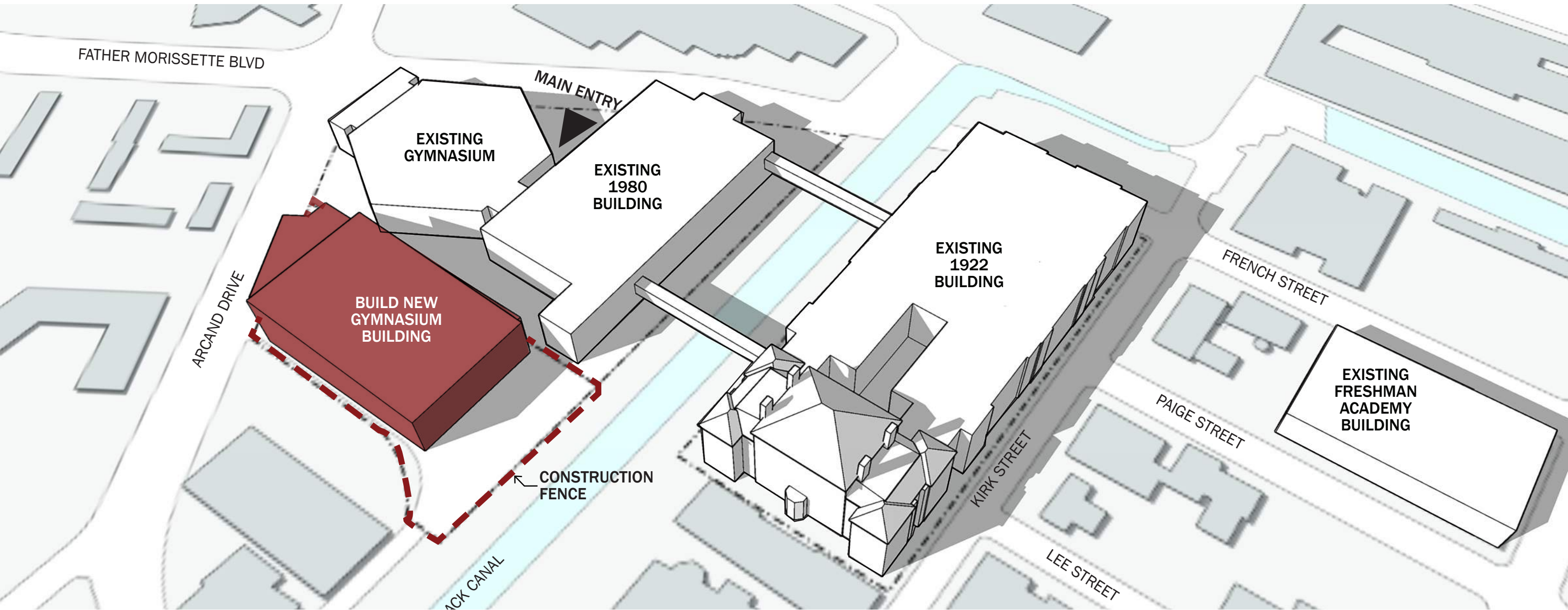

PHASE 1 & 1A

FALL '20 - SPRING '22

- ALL WORK IS OFF-SITE (SCHOOL UNAFFECTED)
- BUILD NEW GYM BLDG. (INCLUDING KITCHEN/BOILER)

PHASING PLAN

SPRING '22 - SUMMER '22

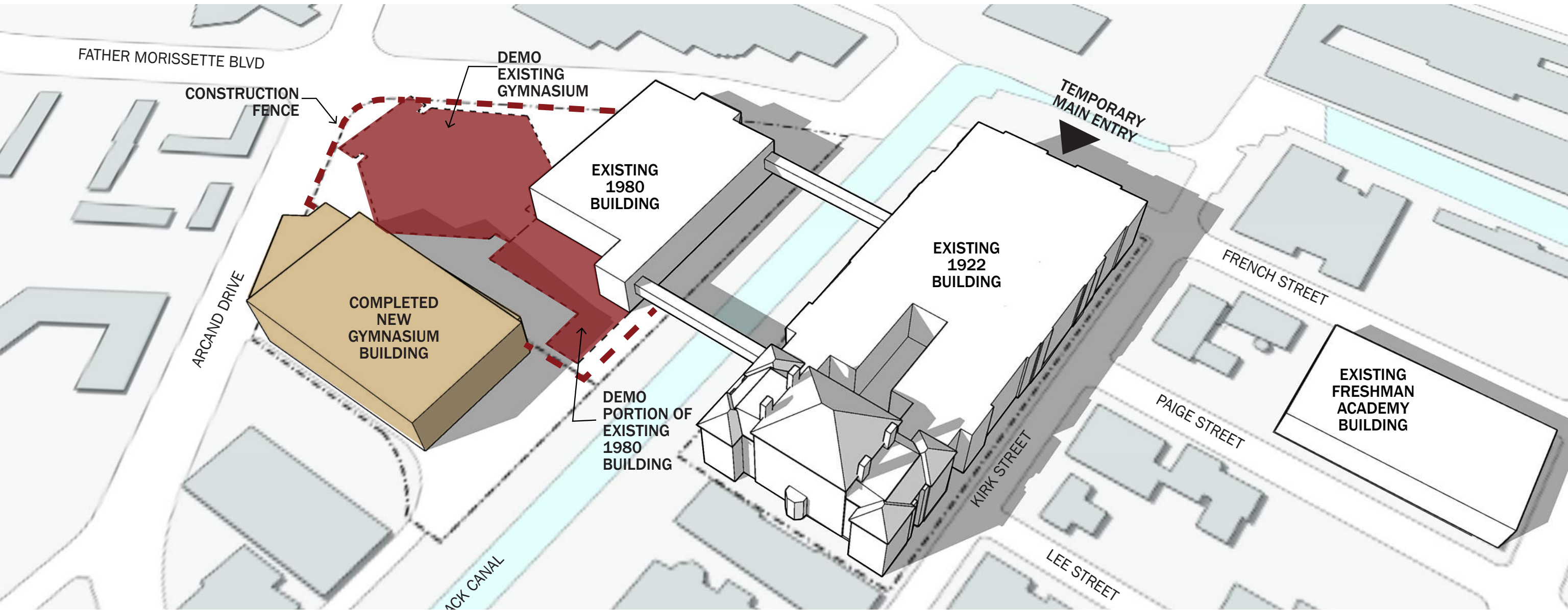

PHASE 2 & 2A

SPRING '22 - SUMMER '22

- DEMO EXISTING GYM
- BUILD SEPARATION WALLS, TEMPORARY CONNECTOR, RELOCATE MAIN ADMIN. AND VACATE SWING SPACE (DURING THE SUMMER)

PHASING PLAN

SUMMER '22 - WINTER '23

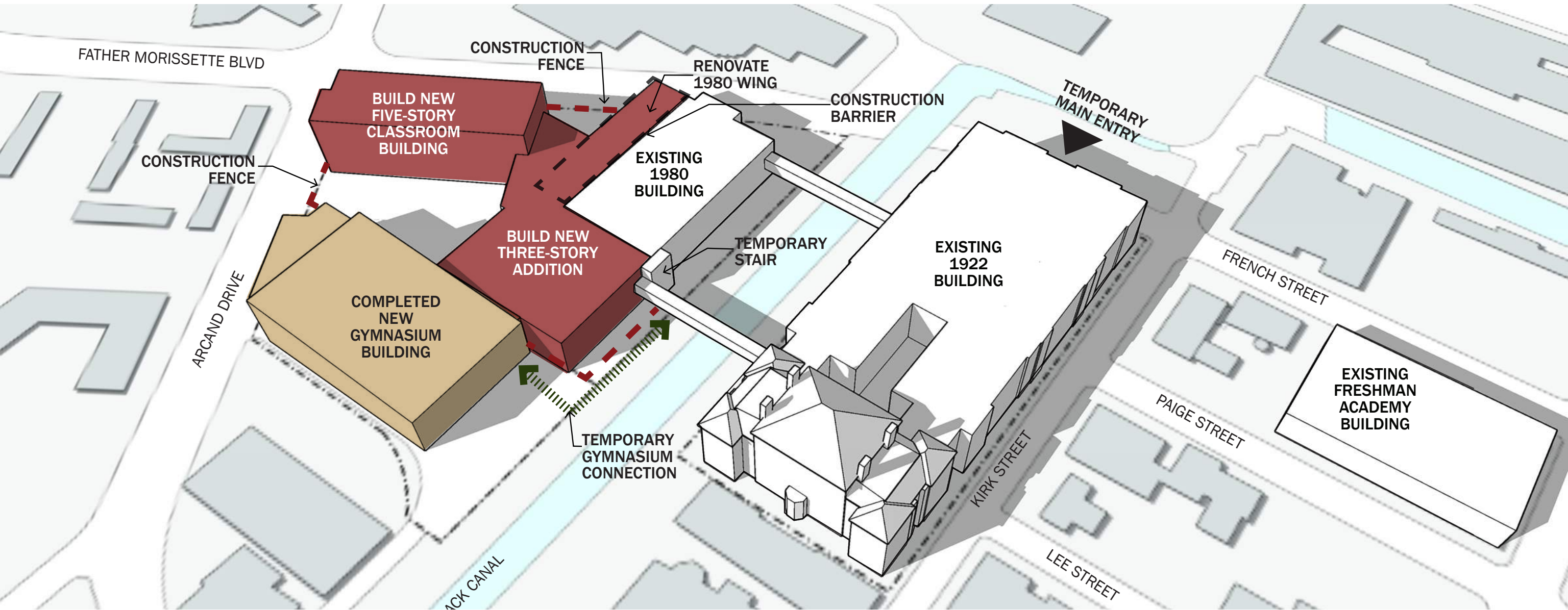

PHASE 2 & 2A

SPRING '22 - WINTER '23

- BUILD NEW FRESHMAN ACADEMY/BUSN-TECH. (CREATES 60 NEW ROOMS)
- RENOVATE WEST SIDE OF 1980 BUILDING

PHASING PLAN

WINTER '24 - SPRING '25

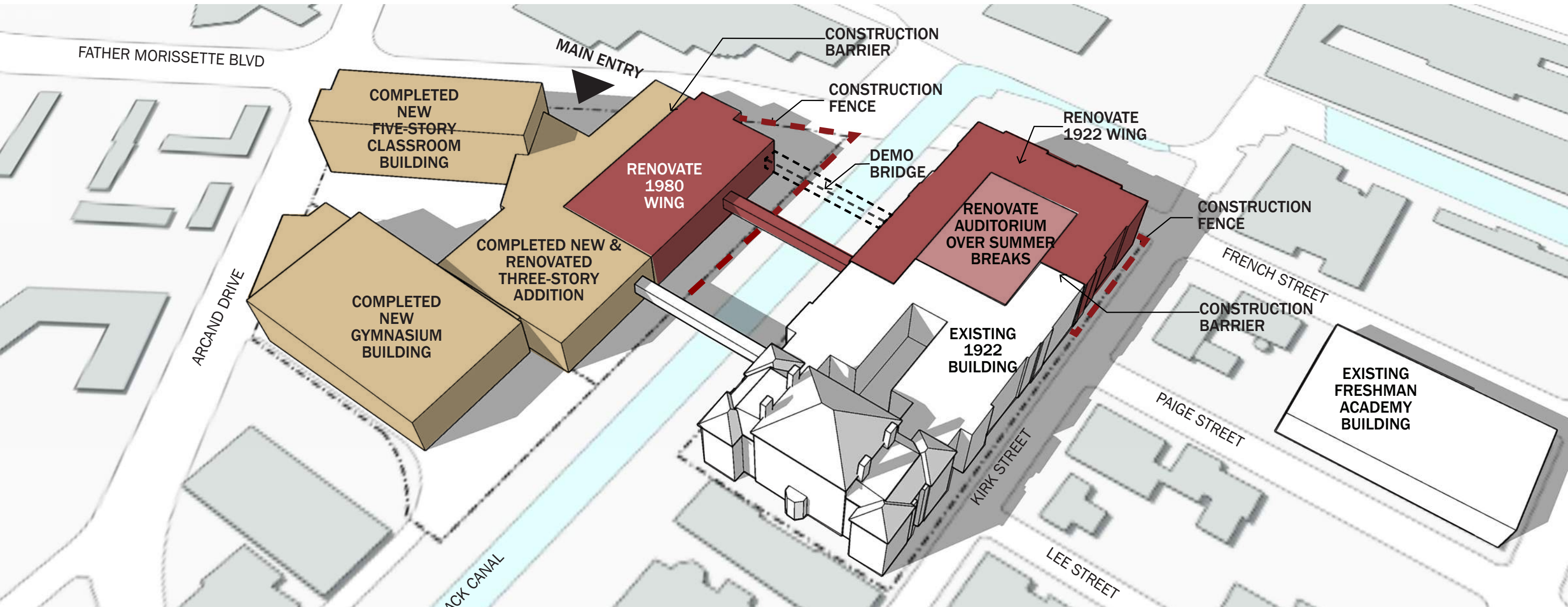

PHASE 3

WINTER '24 - SPRING '25

- RENOVATE BALANCE OF 1980'S & NORTH 1922 BUILDING
- BUILD NEW NORTH BRIDGE
- RENOVATE AUDITORIUM (OVER SUMMER/BREAKS)
- CONTRACTOR USES OLD BRIDGE, THEN DEMOLISH

PHASING PLAN

SUMMER '25 - SUMMER '26

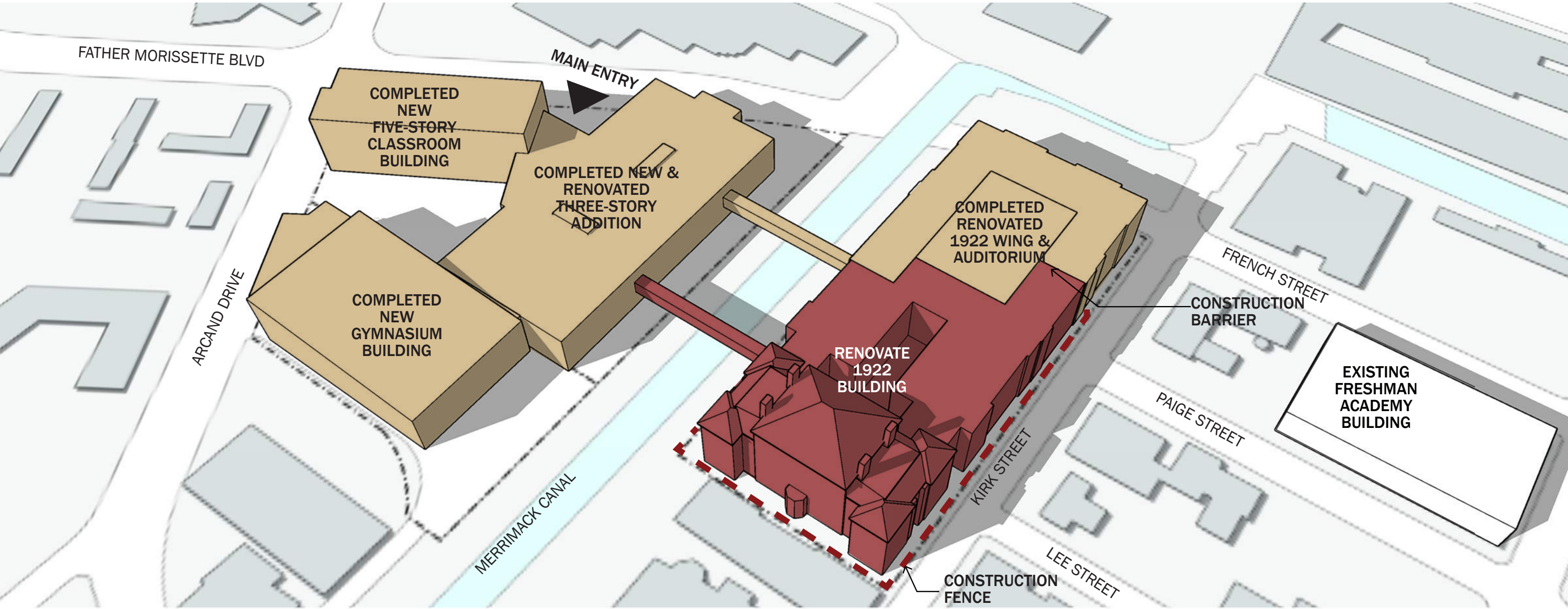

PHASE 4

SPRING '25 - SUMMER '26

- RENOVATE REMAINDER OF 1922 BUILDING
- REBUILD SOUTH BRIDGE
- FRESHMAN RELOCATED TO NEW FACILITIES

PHASING PLAN

FALL '26

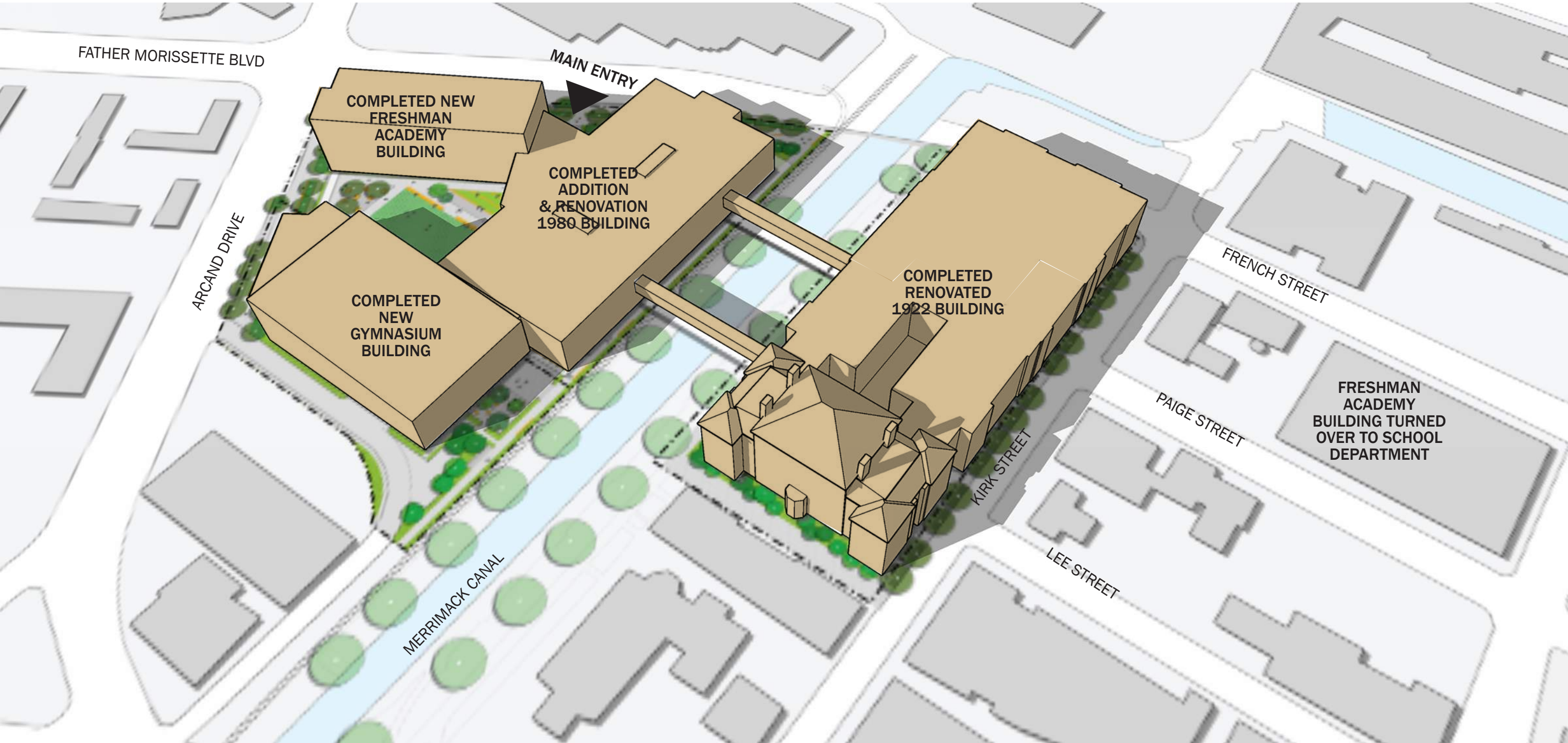

PHASED OCCUPIED CONSTRUCTION

CONSTRUCTION GOALS

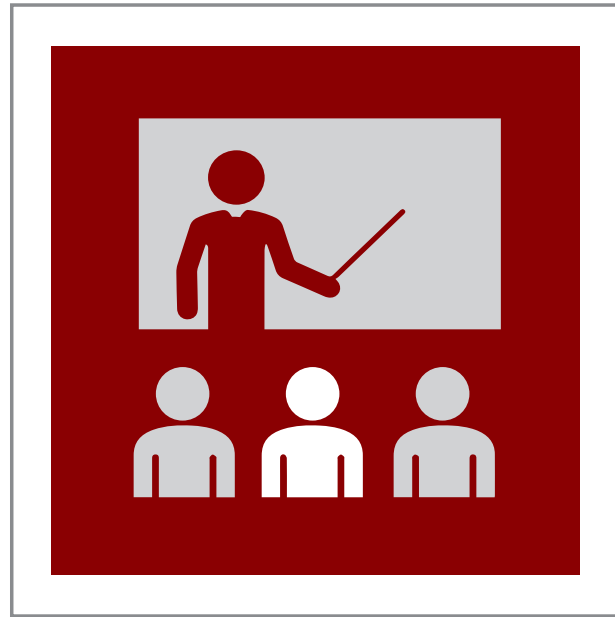

1
CONTINUITY OF
EDUCATION



2
SEPARATION OF
CONSTRUCTION



3
SAFETY
FOR ALL

PHASED OCCUPIED CONSTRUCTION

IMPLEMENTATION

1. SEPARATED ZONES

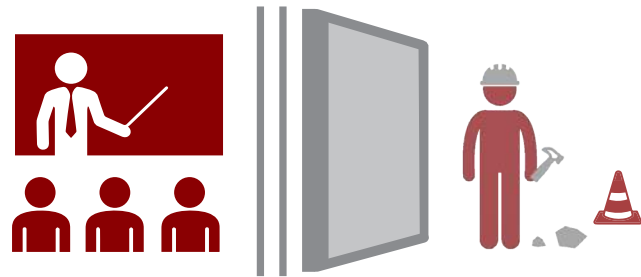

(INCLUDING STACKED)



2. MAINTAIN SEPARATE STAIRS & HALLWAYS



3. ACOUSTIC BUFFER SPACE

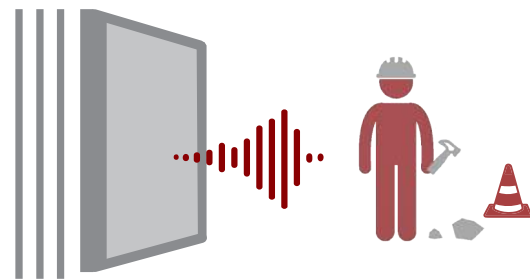

4. BUILT BARRIERS/SEALED



5. REGULAR AIR QUALITY TESTING

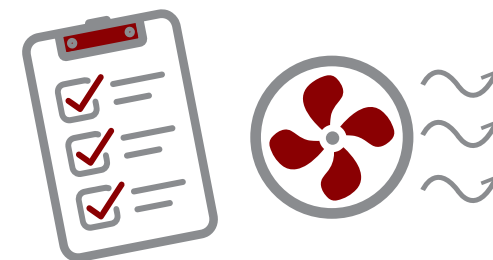

6. NEGATIVE AIR PRESSURE

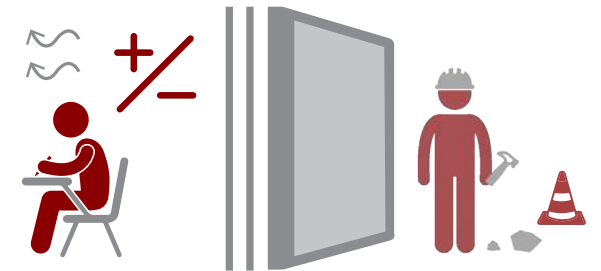

7. CONTINUITY OF (UTILITY) SERVICES

(sequenced phases from new & back to existing)

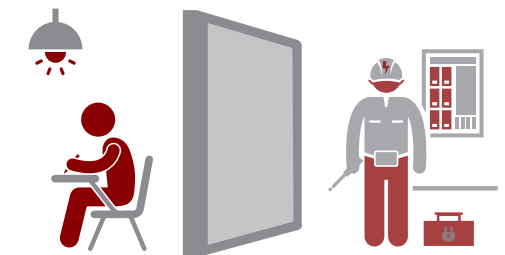

PHASED OCCUPIED CONSTRUCTION

SEPARATED ZONES - INTERIOR



TEMPORARY PARTITION ACROSS HALLWAY
EAST BUILDING

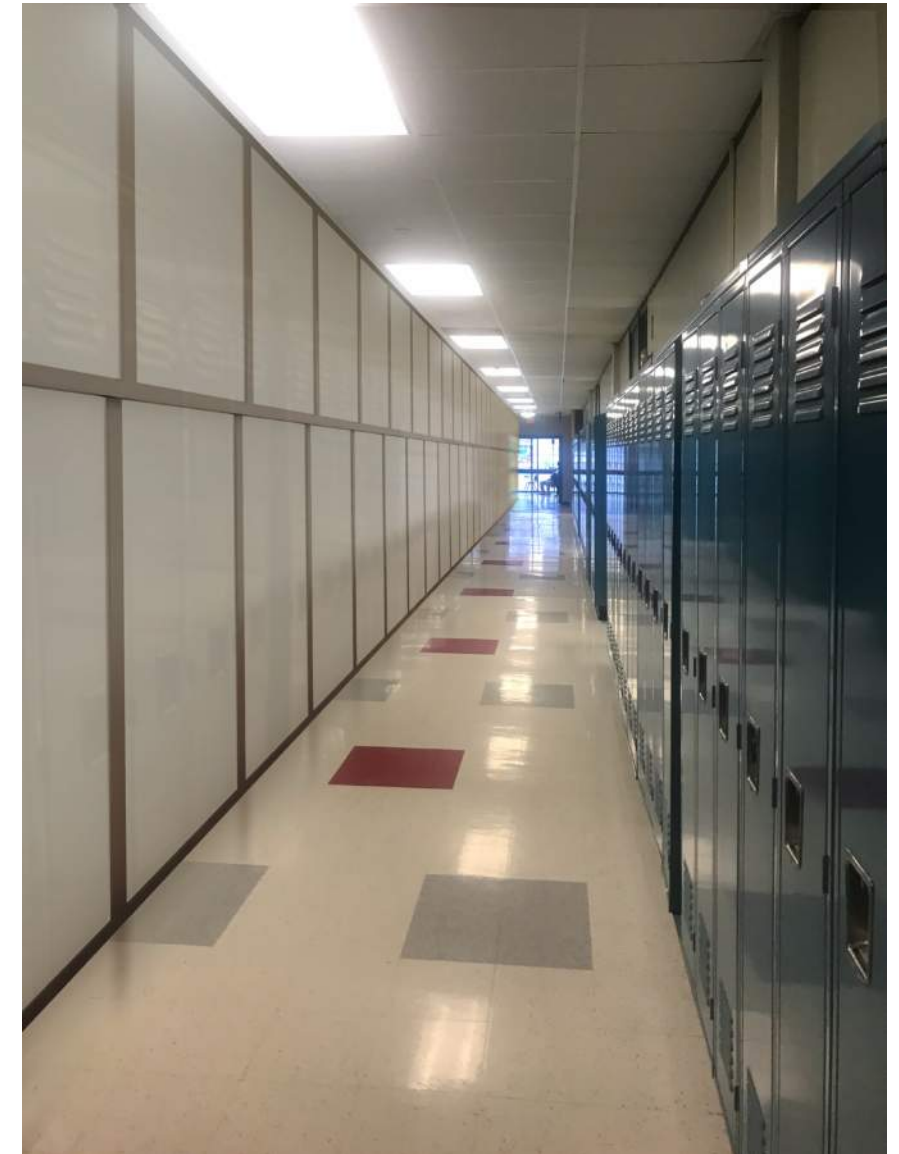

TEMPORARY PARTITION ALONG HALLWAY
WEST BUILDING

PHASED OCCUPIED CONSTRUCTION

SEPARATED ZONES - EXTERIOR

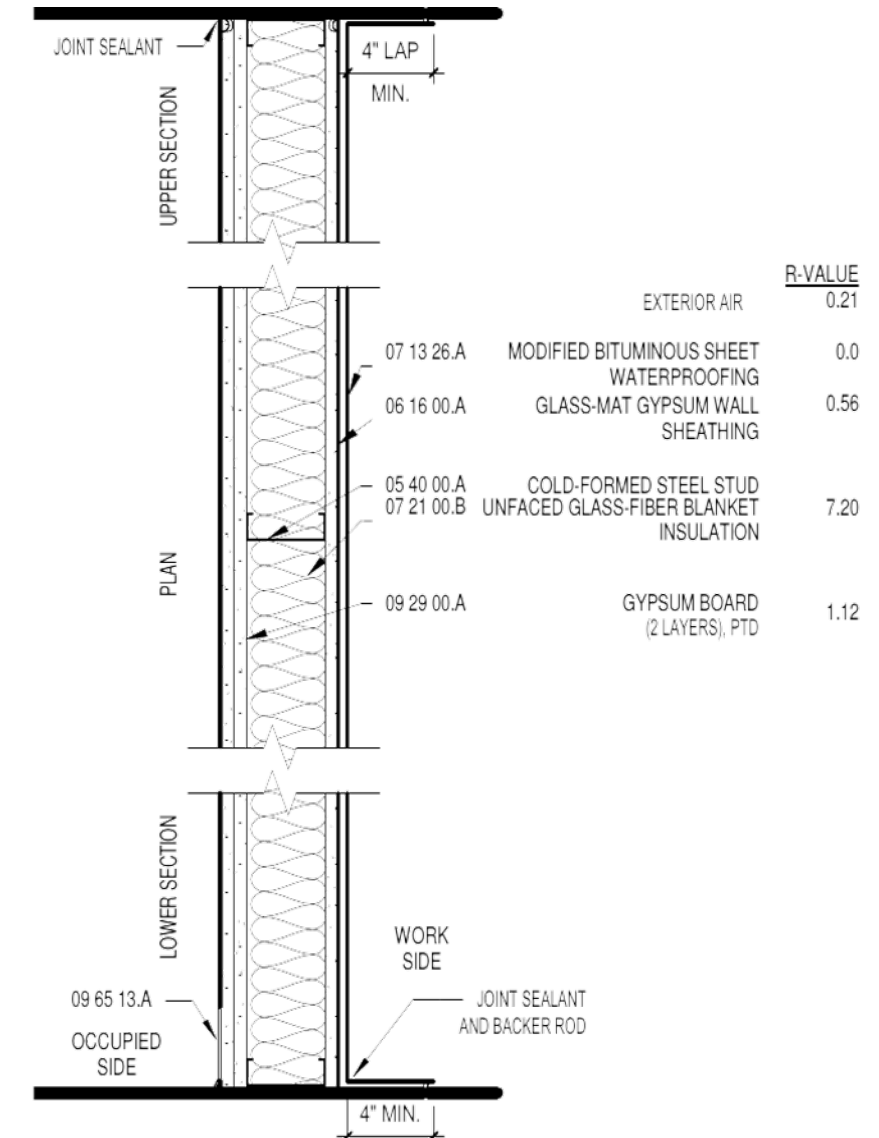

TWA-1 TEMPORARY PARTITION - EXTERIOR

ASSEMBLY R-VALUE: 9.09
STC RATING: 55

LOWELL HIGH SCHOOL

PERKINS —
EASTMAN



FOR MORE INFORMATION VISIT:

[HTTP://WWW.LOWELLHSPROJECT.COM/](http://www.lowellhsp.com/)